

LiDAR data
flown in October 2013
(80m)

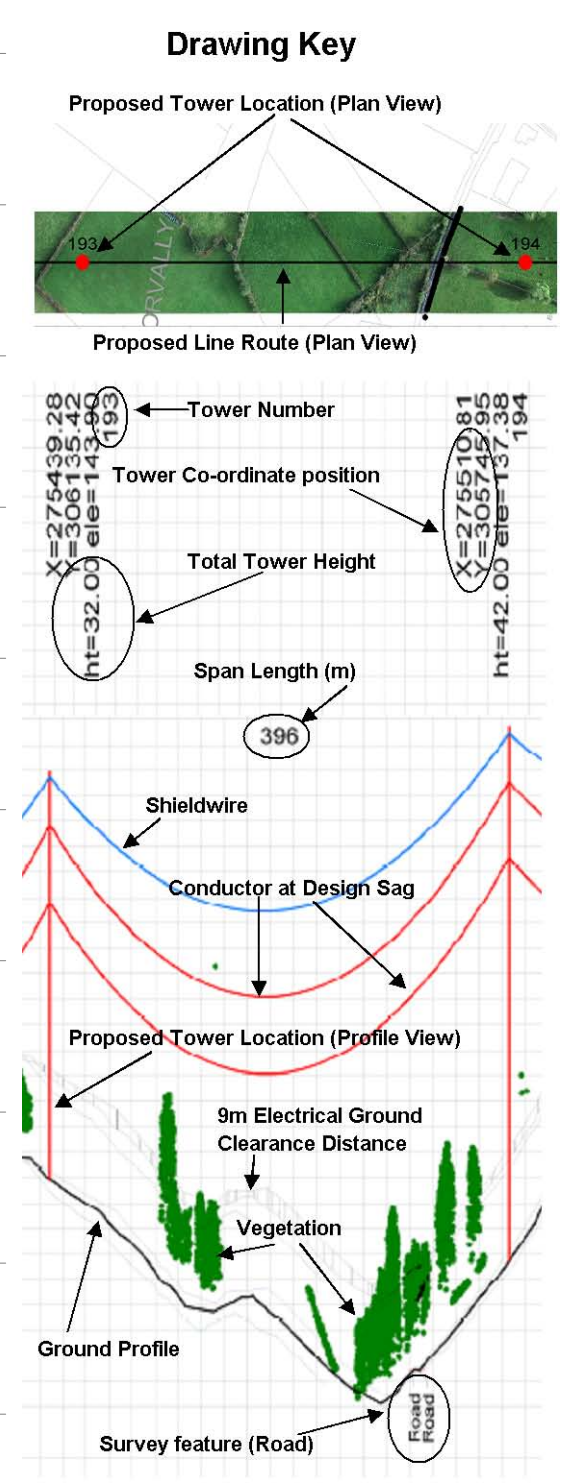
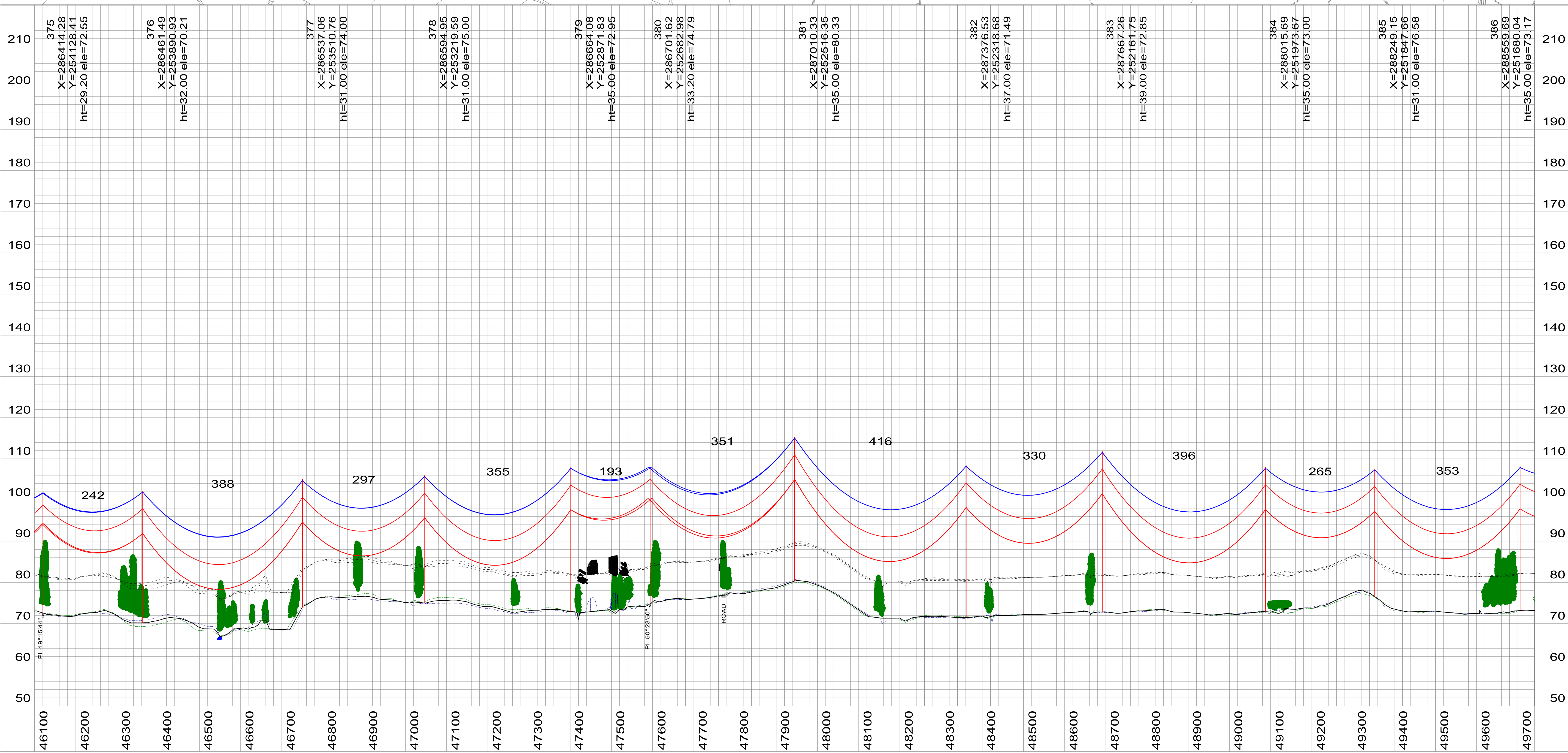

NOTES:
1.- Figure dimensions only to be taken from this drawing. do not scale from this drawing.
2.- Ordnance Survey Ireland Licence number EN 0061514.
3.- Ordnance Survey Ireland/Government of Ireland.
4.- All levels relate to Ordnance Survey datum at Malin Head.

DRAFT					
2	DEC 14	CGV	BCP	RTJ	CIR
ISSUE	DATE	DRAWN	PRJCTD	REVWD	APPRVD
					Planning
					ISSUED FOR

gasNatural fenosa engineering

Patrick J. Tobin & Co. Ltd.

SIZE: A1
SCALE: H= 1:5000, V= 1:500

PROJECT TITLE: NORTH-SOUTH 400 kV INTERCONNECTION DEVELOPMENT
DRAWING TITLE: PROPOSED ROUTE MEATH AREA STUDY PLAN AND PROFILE DRAWINGS

GNFE Document: 20599100003
SHEET: 29 of 32
CLIENT REF: MT-005-029